

CAPACITA' FORATURA
DRILLING CAPACITY $\phi 12$

VH

modello 10

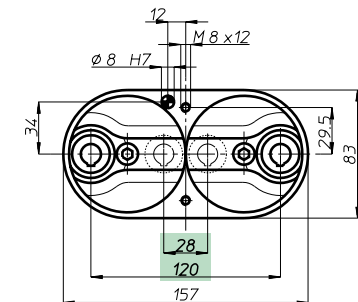
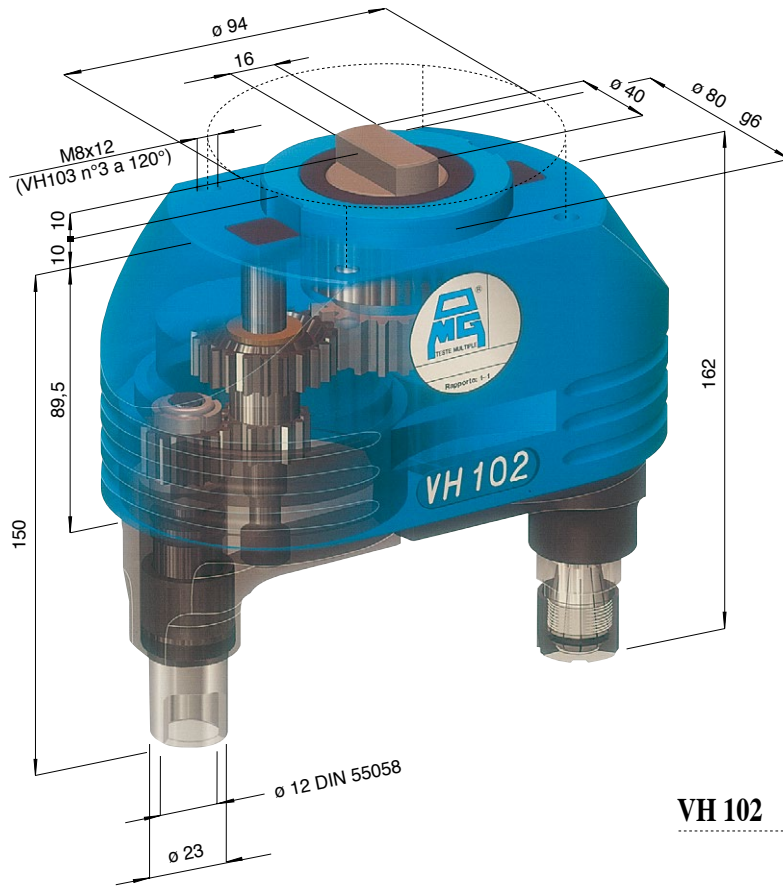

VH 102

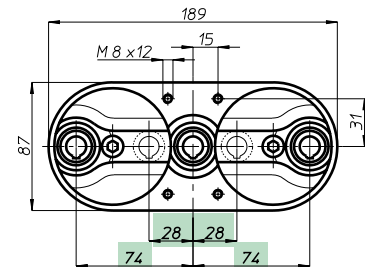

VH 103 L

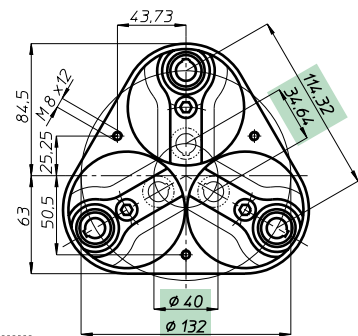

VH 103

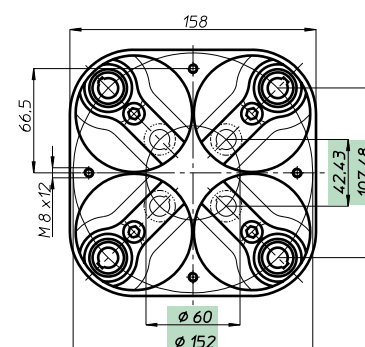

VH 104

Testa modello Head type	VH 102	VH 103 L	VH 103	VH 104
Articolo Item	VH 102 P	VH 103 LP	VH 103 P	VH 104 P
Attacco utensile Spindle type	ER 16 - max $\phi 10$			
Articolo Item	VH 102 D	VH 103 LD	VH 103 D	VH 104 D
Attacco utensile Spindle type	DIN 55058 - $\phi 12$			
N. mandrini Spindles nr.	2	3	3	4
Campo di lavoro min.	28	28 + 28	$\phi 40$	$\phi 60$
Centre distances max.	120	74 + 74	$\phi 132$	$\phi 152$
Capacità foratura Drilling capacity	Acciaio Rm 500 N/mm ² - $\phi 10$			
Maschiatura Tapping	Ghisa GG25 - $\phi 12$			
Rapporto Ratio	M 8			
Velocità RPM	1 - 1			
Peso Weight	3,5	4,9	4,9	7,2

Teste multiple ad assi variabili • Variable axis heads

BAH

TA-CP

TA

MO

HT

VH

TSI/TSX

T

MT-TC-TC3

Accessori
Accessories

Appendice tecnica
Technical supplement

6-8

